



LM35 SERIES

Surface Module 2X4 LED Lens Luminaire

Fixture Type: _____

Job Information: _____

SPECIFICATIONS:

LED MODULES:

- High performance linear configured LED module boards.
- Each board consists of multiple mid-power, high efficacy LEDs in a precise layout eliminating the need for supplemental heat sinking.
- The boards produce an even and diffuse light which maximizes optical efficiency.
- Compatible with the dimming performance of the LED driver.
- Color temperatures available: 3000K, 3500K and 4000K.
- Upon request: 5000K.

LED DRIVERS:

- Factory programmable constant current LED power supply.
- Multiple standard drive current outputs (factory set by Mercury) are cataloged with their corresponding lumen package offerings. Upon request, custom drive current outputs and lumen packages are available.
- Universal voltage input, 120V-277V, 50HZ-60HZ.
- Specification grade dimming down to 1% on 0-10V dimming controls.
- Optional pre-configured drive current drivers are available. Non-dimming.

LED LUMEN PACKAGES:

- Cataloged standard lumen packages. See attached chart for full details.
- Custom lumen packages pre-set are optional. Contact factory for details.

HOUSING:

- All metal parts are fabricated in a computer-controlled operation from heavy gauge code grade cold rolled steel.
- Mitered ends are welded into place for strength and unity.
- Heavy gauge flush steel frame has mitered-look corners. Hinges down or may be completely removed. Two positive action cam latches hold the frame closed.
- A custom formulated non-glare white powder coating is applied to the housing after fabrication.

DIFFUSERS:

- Extruded flat from 100% acrylic clear material.
- High performance prismatic pattern in standard thickness or optional .125" thickness.
- Optional custom formulated high transmission acrylic material.
- Other options upon request.

STANDBY LIGHTING OPTION:

- Self contained module, 5W, 7W, 10W or 12W as specified. Battery backup upon loss of power.

INSTALLATIONS:

- Designed for surface mounting direct to most ceiling types.
- May be suspended on auxiliary hanging hardware.
- Sufficient knockouts are provided on the back of the housing for all electrical connections.
- Blind knockouts on the ends for surface conduit entry on request.

CERTIFICATE OF SAFETY

COMPLIANCE AND LISTINGS:

- Luminaire: UL and CUL listed 1598 and bears their label. Suitable for dry locations or optional damp locations with UL Damp Label.

WARRANTY:

- 5-year limited warranty is standard. Special 10-year warranty available on a job-to-job basis. Complete LED warranty terms available at www.mercltg.com.
- Actual performance may differ as a result of end-user environment and application.
- Most LED luminaires are suitable to operate in ambient temperatures from -20C (-4F) to 25C (77F).
- The following exclusions apply: Luminaires with optional standby lighting option, integral lighting controls options, or wireless control options. Consult factory.
- LM-79 testing was measured under a controlled 25C (77F) ambient operating temperature.

FEATURES:

- Surface module full size 2X4 ambient LED luminaire.
- For use where recessing is not possible or desirable, or when high ceilings necessitates suspending down to reasonable heights.
- Hinged door frame encases an acrylic prismatic clear diffuser.
- Diffuses the LED light source in a very wide and efficient distribution delivering a balanced amount of horizontal and vertical illumination.
- Digital LED technology provides high efficacy and energy efficiency.
- Multiple power and light levels are offered as standard to allow meeting design and energy needs per application. Custom factory set levels available on request.
- Lumen maintenance; Reported L70 (hours) & L80 (hours) > 60,000.
- CRI greater than 80.
- Fixture lumens per watt ratios up to 116.



LM35 SERIES

Fixture Type:

Job Information:

ORDERING DATA: Fill in boxes below with corresponding bold options.

Example: LM35-24M-5100-35K-9A-1%-UNI-EM7

SERIES	MODULE SIZE/CEILING	NOMINAL LUMENS	COLOR TEMP	DIFFUSER	DRIVER	VOLTAGE	STANDBY LIGHTING OPTIONS
LM35	24M 2X4 Surface Module.	3300 4200 5100 5800 8900	30K 35K 40K 50K Upon Request	9A Acrylic Prismatic Clear 9A.125 Acrylic Prismatic Clear .125" HTA High Transmission Acrylic Frosted	1% 0-10V 1% Dimming As Specified	UNI	EM5 EM7 EM10 EM12
		XXXX Custom Lumen Package. Contact Factory.					

LUMEN PACKAGE

SERIES	MODULE SIZE	Nominal Lumen Package	Color	Fixture Power (W)	Diffuser	Delivered Lumens	Fixture LPW
LM35	2X4						
		3300	3000K	31	9A	3148	102
		3300	3500K	31	9A	3207	104
		3300	4000K	31	9A	3320	108
		3300	5000K	31	9A	3436	112
		4200	3000K	38	9A	4051	107
		4200	3500K	38	9A	4128	109
		4200	4000K	38	9A	4274	112
		4200	5000K	38	9A	4423	116
		5100	3000K	47	9A	4852	104
		5100	3500K	47	9A	4944	106
		5100	4000K	47	9A	5118	110
		5100	5000K	47	9A	5298	114
		5800	3000K	55	9A	5590	102
		5800	3500K	55	9A	5697	104
		5800	4000K	55	9A	5897	108
		5800	5000K	55	9A	6103	111
		8900	3000K	91	9A	8478	94
		8900	3500K	91	9A	8639	95
		8900	4000K	91	9A	8943	99
		8900	5000K	91	9A	9256	102

Actual wattage may differ by +/- 5% when operating between 120V-277V +/- 10%.

PHOTOMETRICS:

All photometric reports are available at www.mercltg.com.

CROSS SECTIONS:

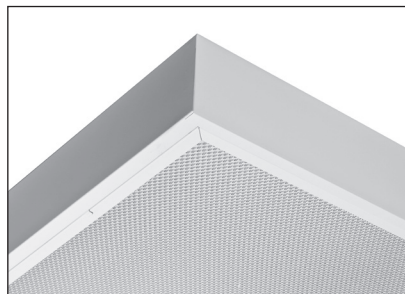
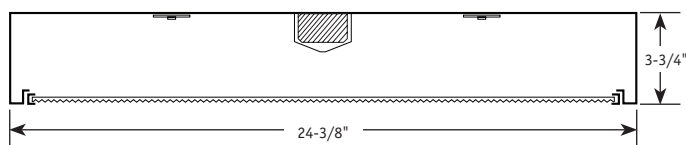

Detail

