



LR10 SERIES

Architectural Recessed 2X2 LED Volume Luminaire

Fixture Type: _____

Job Information: _____

SPECIFICATIONS:

LED MODULES:

- High performance linear configured LED module boards.
- Each board consists of multiple mid-power, high efficacy LEDs in a precise layout eliminating the need for supplemental heat sinking.
- The boards produce an even and diffuse light which maximizes optical efficiency.
- Compatible with the dimming performance of the LED driver.
- Color temperatures available: 3000K, 3500K and 4000K.
- Upon request: 5000K.

LED DRIVERS:

- Factory programmable constant current LED power supply.
- Multiple standard drive current outputs (factory set by Mercury) are cataloged with their corresponding lumen package offerings. Upon request, custom drive current outputs and lumen packages are available.
- Note: Certain cataloged lumen packages may be provided with a non-programmable constant current LED power supply at Mercury's discretion. Contact factory if critical.
- Universal voltage input, 120V-277V, 50HZ-60HZ.
- Specification grade dimming down to 1% on 0-10V dimming controls.

LED LUMEN PACKAGES:

- Cataloged standard lumen packages. See attached chart for full details.
- Custom lumen packages pre-set are optional with programmable drivers only. Contact factory for details.

HOUSING:

- All metal parts are fabricated in a computer-controlled operation from heavy gauge code grade cold rolled steel.
- Rivets hold all parts together for strength and unity.
- A custom formulated non-glare white powder coating is applied to the housing after fabrication providing a reflectivity of at least 90%.

DIFFUSER:

- Small-scale tear drop profile design.
- Extruded from custom formulated high transmission acrylic material.
- Linear ribbing for high LED performance.

STANDBY LIGHTING OPTION:

- Self contained module, 5W, 7W, 10W or 12W as specified. Battery backup upon loss of power.
- May not be available with some higher lumen packages. See Lumen package matrix.

INSTALLATIONS:

- Designed for installation into NEMA Type G lay-in acoustical grid ceiling systems, 1" grid or 9/16" fine-line grid.
- For NEMA Type F dry wall applications an additional flange kit must be used with Type G housing.
- Four pry-out style grid support clips are located on the housing sides.
- Four auxiliary suspension points are also provided for securing to building structure.
- A quick wiring access plate is located on back of the housing. Additional knockouts provided.
- Factory installed power whips as specified.

CERTIFICATE OF SAFETY

COMPLIANCE AND LISTINGS:

- Luminaire: UL and CUL listed 1598 and bears their label. Suitable for damp locations.
- IC rated. (Some higher lumen packages may not qualify. See Lumen Package matrix).

WARRANTY:

- 5-year limited warranty is standard. Special 10-year warranty available on a job-to-job basis. Complete LED warranty terms available at www.mercltg.com.
- Actual performance may differ as a result of end-user environment and application.
- Most LED luminaires are suitable to operate in ambient temperatures from -20C (-4F) to 25C (77F).
- The following exclusions apply: Luminaires with optional standby lighting option, integral lighting controls options, or wireless control options. Consult factory.
- LM-79 testing was measured under a controlled 25C (77F) ambient operating temperature.

FEATURES:

- Shallow recessed 2X2 ambient LED luminaire featuring a single linear high transmission acrylic diffuser.
- Small-scale tear drop diffuser envelopes the LED light source allowing maximum light transmission while eliminating pixillations and hot spots.
- Delivers a balanced amount of horizontal and vertical illumination.
- Digital LED technology provides high efficacy and energy efficiency.
- Multiple power and light levels are offered as standard to allow meeting design and energy needs per application. Custom factory set levels available on request.
- Lumen maintenance; Reported L70 (hours) & L80 (hours) > 60,000.
- CRI greater than 80.
- Fixture lumens per watt ratios up to 119.
- American Made.
- Matching surface luminaire: LW10 Series.



LR10 SERIES

Fixture Type:

Job Information:

ORDERING DATA: Fill in boxes below with corresponding bold options.

Example: LR10-22G-3000-35K-1%-UNI-EM7

SERIES	MODULE SIZE/CEILING	NOMINAL LUMENS	COLOR TEMP	DRIVER	VOLTAGE	STANDBY LIGHTING OPTIONS	OPTIONS
LR10	22G 2X2 Module/ Nema Type G/Lay-In Grid, 1" or 9/16" Fine Line.	2300 2600 3000 3400 3800 4100 XXXX Custom Lumen Package. Contact Factory.	30K 35K 40K 50K Upon Request	1% 0-10V 1% Dimming As Specified	UNI	EM5 EM7 EM10 EM12	FLX 6Ft. Single Circuit Power Flex (Specify Voltage) FLX2 6Ft. 2-Circuit Power Flex (Specify Voltage)

LUMEN PACKAGE

SERIES	MODULE SIZE	Nominal Lumen Package	Color	Fixture Power (W)	Delivered Lumens	Fixture LPW	IC Rated	Standby Lighting Option
LR10	2X2							
		2300	3000K	20	2201	110	✓	✓
		2300	3500K	20	2236	112	✓	✓
		2300	4000K	20	2305	116	✓	✓
		2300	5000K	20	2374	119	✓	✓
		2600	3000K	23	2488	107	✓	✓
		2600	3500K	23	2527	109	✓	✓
		2600	4000K	23	2605	112	✓	✓
		2600	5000K	23	2683	116	✓	✓
		3000	3000K	26	2892	110	✓	✓
		3000	3500K	26	2937	112	✓	✓
		3000	4000K	26	3028	115	✓	✓
		3000	5000K	26	3119	119	✓	✓
		3400	3000K	31	3286	106	✓	✓
		3400	3500K	31	3338	108	✓	✓
		3400	4000K	31	3441	111	✓	✓
		3400	5000K	31	3544	115	✓	✓
		3800	3000K	35	3664	103	✓	✓
		3800	3500K	35	3721	105	✓	✓
		3800	4000K	35	3836	108	✓	✓
		3800	5000K	35	3951	111	✓	✓
		4100	3000K	40	3938	100	—	✓
		4100	3500K	40	4000	101	—	✓
		4100	4000K	40	4124	104	—	✓
		4100	5000K	40	4248	107	—	✓

Actual wattage may differ by +/- 5% when operating between 120V-277V +/- 10%.

PHOTOMETRICS:

All photometric reports are available at www.mercltq.com.

CROSS SECTIONS:

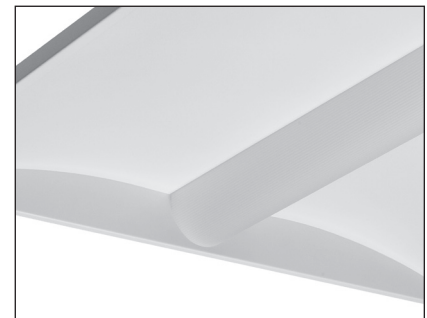
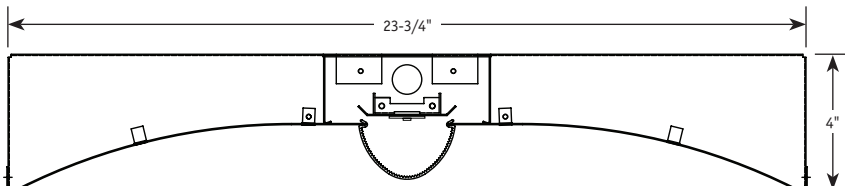

Detail

