

LW14 SERIES

Architectural Linear Ambient LED Luminaire

Fixture Type: _____

Job Information: _____

SPECIFICATIONS:

LED MODULES:

- High performance linear configured LED module boards.
- Each board consists of multiple mid-power, high efficacy LEDs in a precise layout eliminating the need for supplemental heat sinking.
- The boards produce an even and diffuse light which maximizes optical efficiency.
- Compatible with the dimming performance of the LED driver.
- Color temperatures available: 3000K, 3500K and 4000K.
- Upon request: 5000K.

LED DRIVERS:

- Factory programmable constant current LED power supply.
- Multiple standard drive current outputs (factory set by Mercury) are cataloged with their corresponding lumen package offerings. Upon request, custom drive current outputs and lumen packages are available.
- Note: Certain cataloged lumen packages may be provided with a non-programmable constant current LED power supply at Mercury's discretion. Contact factory if critical.
- Universal voltage input, 120V-277V, 50HZ-60HZ.
- Specification grade dimming down to 1% on 0-10V dimming controls.

LED LUMEN PACKAGES:

- Cataloged standard lumen packages. See attached chart for full details.
- Custom lumen packages pre-set are optional with programmable drivers only. Contact factory for details.

HOUSING:

- Fabricated from heavy gauge code grade cold rolled steel with a white polyester powder coating finish for long lasting durability.
- Housing ends are welded into place.
- Sufficient electrical knockouts are provided on the housing back and ends.

REFLECTOR OPTIONS:

- Side reflectors are factory installed or can be field installed to the housing.
- May be used individually for one-side asymmetric function or in pairs for dual-side symmetric function.
- Aperture option; a series of architectural apertures allows a segment of up lighting.

DIFFUSER:

- Larger-scale rounded profile design.
- Extruded from custom formulated high transmission acrylic material.
- Linear ribbing for high LED performance.

STANDBY LIGHTING OPTION:

- Self contained module, 7W, 10W or 12W as specified. Battery backup upon loss of power.

OPTIONAL INTEGRAL LIGHTING CONTROLS:

- Self-contained motion sensors mount directly to luminaire.
- Passive infrared (PIR) technology for individual luminaire control.
- On/Off control with optional delay features.
- See ordering matrix for available sensors.
- System lighting controls available. Contact factory.

INSTALLATIONS:

- May be installed in any direction, individually or in continuous run applications.
- May be surface mounted or suspended.
- End knockouts for surface conduit entry.

CERTIFICATE OF SAFETY

COMPLIANCE AND LISTINGS:

- Luminaire: UL and CUL listed 1598 and bears their label. Suitable for damp locations.
- DesignLights Consortium (DLC) qualified product. Not all versions of this product may be DLC qualified. Check at www.designlights.org/QPL to confirm.

WARRANTY:

- 5-year limited warranty is standard. Special 10-year warranty available on a job-to-job basis. Complete LED warranty terms available at www.mercltg.com.
- Actual performance may differ as a result of end-user environment and application.
- Most LED luminaires are suitable to operate in ambient temperatures from -20C (-4F) to 25C (77F).
- The following exclusions apply: Luminaires with optional standby lighting option, integral lighting controls options, or wireless control options. Consult factory.
- LM-79 testing was measured under a controlled 25C (77F) ambient operating temperature.

FEATURES:

- Shallow form linear ambient LED luminaire.
- Larger-scale rounded profile acrylic diffuser evenly surrounds the LED light source enabling a very wide and near-perfect light distribution.
- Compact design complies with all ADA requirements for public areas.
- Custom formulated high diffusion acrylic material allows for maximum light transmission while eliminating pixilation and hot spots.
- Optional integral side reflectors add both function and architectural contour.
- Nominal 2Ft., 4Ft. or 8Ft. long modules.
- Digital LED technology provides high efficacy and energy efficiency.
- Multiple power and light levels are offered as standard to allow meeting design and energy needs per application. Custom factory set levels available on request.
- Lumen maintenance; Reported L70 (hours) & L80 (hours) > 60,000.
- CRI greater than 80.
- Fixture lumens per watt ratios up to 130.
- American Made.



LW14 SERIES

Fixture Type:

Job Information:

ORDERING DATA: Fill in boxes below with corresponding bold options.

Example: LW14-4-3800-35K-HTA-1%-UNI-EM7

SERIES	NOMINAL LENGTH (FT)	NOMINAL LUMENS	COLOR TEMP	DIFFUSER	DRIVER	VOLTAGE	OPTIONS
LW14	2 24" Length	24"L 2100	30K	HTA High Transmission Acrylic	1% 0-10V 1% Dimming	UNI	Side Reflectors SR Symmetric Function Set of 2 Side Reflectors AR Asymmetric Function 1 Side Reflector SRA Symmetric Function Aperture Reflectors Standby Modules EM7 EM10 EM12 Optional Integral Lighting Controls 01 Leviton OSFHU mounts externally, for higher ceilings. 04 Wattstopper FS-155-1 mounts internally with only the PIF dome visible. 05 Leviton OSF10 mounts internally with only the PIF dome visible.
	4 45" Length	2300	35K				
	8 96" Length	2500	40K				
		2700	50K Upon Request				
		45"L 2100					
		3800					
		4500					
		5000					
		7800					
		10000					
		96"L 6000					
		8000					
		10000					
		20000					
		XXXX Custom Lumen Package. Contact Factory.					

HANGING ACCESSORIES

PART #	DESCRIPTION
R5PF-100	Round 5" power feed canopy, Hanging hardware, 100" long 1/16" cable.
R5-100	Round 5" canopy, Hanging hardware, 100" long 1/16" cable.
R2-100	Round 2" canopy, Hanging hardware, 100" long 1/16" cable.
S5PF-100	Square 5" power feed canopy, Hanging hardware, 100" long 1/16" cable.
S5-100	Square 5" canopy, Hanging hardware, 100" long 1/16" cable.
S2-100	Square 5" power feed canopy, Hanging hardware, 100" long 1/16" cable.

PART #	DESCRIPTION
VH-XX	"V" Hanger w/XX= 48"L or 72"L Chain & "S" Hook
CPYS-1	S-1 Single Stem 5" Dia. Canopy
STMXX	XX= 12"L, 24"L, 48"L Stem/ 3/8" IPS-5/8" OD

Other cable lengths available.

PHOTOMETRICS:

All photometric reports are available at www.mercltg.com.

CROSS SECTIONS:

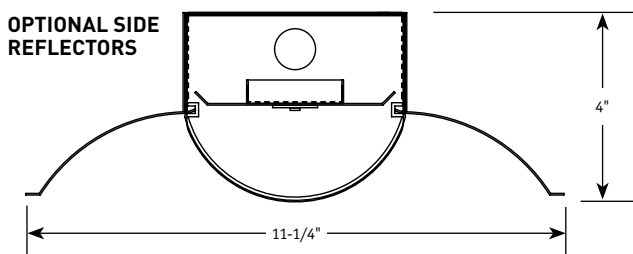
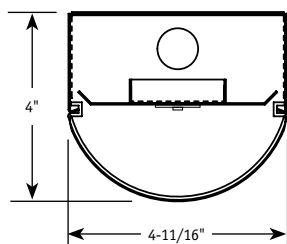

LW14 SERIES

Fixture Type:

Job Information:

LUMEN PACKAGE:

NOMINAL LENGTH: 2FT.

SERIES	NOMINAL LENGTH (FT)	Nominal Lumen Package	Color	Fixture Power (W)	Delivered Lumens	Fixture LPW	DLC	SR OPTION DLC
LW14	2							
		2100	3000K	18	2035	111	✓	✓
		2100	3500K	18	2067	113	✓	✓
		2100	4000K	18	2131	116	✓	✓
		2100	5000K	18	2195	120	✓	✓
		2300	3000K	21	2265	108	✓	✓
		2300	3500K	21	2301	110	✓	✓
		2300	4000K	21	2372	113	✓	✓
		2300	5000K	21	2443	117	✓	✓
		2500	3000K	22	2392	107	✓	✓
		2500	3500K	22	2429	108	✓	✓
		2500	4000K	22	2504	112	✓	✓
		2500	5000K	22	2580	115	✓	✓
		2700	3000K	25	2586	105	✓	✓
		2700	3500K	25	2627	106	✓	✓
		2700	4000K	25	2708	110	✓	✓
		2700	5000K	25	2789	113	✓	✓

Actual wattage may differ by +/- 5% when operating between 120V-277V +/- 10%.

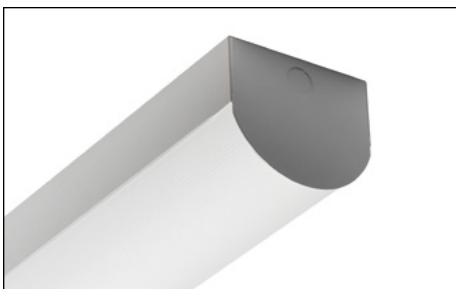

Detail

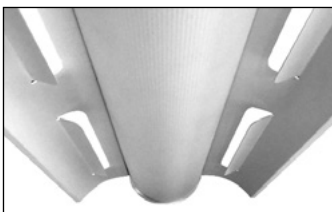

Aperture Reflectors

NOMINAL LENGTH: 4FT.

SERIES	NOMINAL LENGTH (FT)	Nominal Lumen Package	Color	Fixture Power (W)	Delivered Lumens	Fixture LPW	DLC	SR OPTION DLC
LW14	4							
		2100	3000K	18	2025	114	✓	✓
		2100	3500K	18	2056	116	✓	✓
		2100	4000K	18	2120	119	✓	✓
		2100	5000K	18	2184	123	✓	✓
		3800	3000K	32	3649	113	✓	✓
		3800	3500K	32	3706	115	✓	✓
		3800	4000K	32	3821	119	✓	✓
		3800	5000K	32	3935	122	✓	✓
		4500	3000K	39	4314	109	✓	✓
		4500	3500K	39	4382	111	✓	✓
		4500	4000K	39	4517	115	✓	✓
		4500	5000K	39	4653	118	✓	✓
		5000	3000K	45	4821	107	✓	✓
		5000	3500K	45	4897	108	✓	✓
		5000	4000K	45	5048	112	✓	✓
		5000	5000K	45	5200	115	✓	✓
		7800	3000K	76	7520	100	-	-
		7800	3500K	76	7677	101	-	-
		7800	4000K	76	7875	104	-	-
		7800	5000K	76	7915	104	-	-
		10,000	3000K	80	9,750	122	-	-
		10,000	3500K	80	10,067	126	-	-
		10,000	4000K	80	10,267	129	-	-
		10,000	5000K	80	10,388	130	-	-

Actual wattage may differ by +/- 5% when operating between 120V-277V +/- 10%.

NOMINAL LENGTH: 8FT.

SERIES	NOMINAL LENGTH (FT)	Nominal Lumen Package	Color	Fixture Power (W)	Delivered Lumens	Fixture LPW	DLC	SR OPTION DLC
LW14	8							
		6000	3000K	49	5798	118	-	-
		6000	3500K	49	5889	120	-	-
		6000	4000K	49	6071	123	-	-
		6000	5000K	49	6253	127	✓	✓
		8000	3000K	69	7701	112	✓	✓
		8000	3500K	69	7822	114	✓	✓
		8000	4000K	69	8064	117	✓	✓
		8000	5000K	69	8306	121	✓	✓
		10,000	3000K	89	9557	107	-	-
		10,000	3500K	89	9707	108	-	-
		10,000	4000K	89	10,008	112	-	-
		10,000	5000K	89	10,308	115	✓	✓
		20,000	3000K	159	19,500	122	-	-
		20,000	3500K	159	20,134	126	-	-
		20,000	4000K	159	20,534	129	-	-
		20,000	5000K	159	20,776	130	-	-

Actual wattage may differ by +/- 5% when operating between 120V-277V +/- 10%.

