



# LW26 SERIES

## Architectural Wide Footprint Linear LED Luminaire

VERY HIGH LUMEN PACKAGES

Fixture Type: \_\_\_\_\_

Job Information: \_\_\_\_\_

### SPECIFICATIONS:

#### LED MODULES:

- High performance linear configured LED module boards.
- Each board consists of multiple mid-power, high efficacy LEDs in a precise layout eliminating the need for supplemental heat sinking.
- The boards produce an even and diffuse light which maximizes optical efficiency.
- Compatible with the dimming performance of the LED driver.
- Color temperatures available: 3000K, 3500K and 4000K.
- Upon request: 5000K.

#### LED DRIVERS:

- Factory programmable constant current LED power supply.
- Multiple standard drive current outputs (factory set by Mercury) are cataloged with their corresponding lumen package offerings. Upon request, custom drive current outputs and lumen packages are available.
- Note: Certain cataloged lumen packages may be provided with a non-programmable constant current LED power supply at Mercury's discretion. Contact factory if critical.
- Universal voltage input, 120V-277V, 50HZ-60HZ.
- Specification grade dimming down to 1% on 0-10V dimming controls.

#### LED LUMEN PACKAGES:

- Cataloged standard lumen packages. See attached chart for full details.
- Custom lumen packages pre-set are optional with programmable drivers only. Contact factory for details.

#### HOUSING:

- Fabricated from heavy gauge code grade cold rolled steel with housing ends welded into place.
- White polyester powder coating finish for long lasting durability.
- Sufficient electrical knockouts are provided on the housing back and ends.

#### DIFFUSER:

- Nominal nine-inch wide architectural hybrid-shape profile design.
- Extruded from custom formulated high transmission acrylic material.
- Linear ribbing for high LED performance.

#### STANDBY LIGHTING OPTION:

- Self contained module, 7W, 10W or 12W as specified. Battery backup upon loss of power.
- May not be available with some higher lumen packages. See Lumen package matrix.

#### OPTIONAL INTEGRAL LIGHTING CONTROLS:

- Self-contained motion sensors mount directly to luminaire.
- Passive infrared (PIR) technology for individual luminaire control.
- On/Off control with optional delay features.
- See ordering matrix for available sensors.
- System lighting controls available. Contact factory.

#### INSTALLATIONS:

- May be installed in any direction, individually or in continuous run applications.
- May be surface mounted or suspended.
- End knockouts for surface conduit entry.

#### CERTIFICATE OF SAFETY COMPLIANCE AND LISTINGS:

- Luminaire: UL and CUL listed 1598 and bears their label. Suitable for damp locations.
- DesignLights Consortium (DLC) qualified product. Not all versions of this product may be DLC qualified. Check at [www.designlights.org/QPL](http://www.designlights.org/QPL) to confirm.

#### WARRANTY:

- 5-year limited warranty is standard. Special 10-year warranty available on a job-to-job basis. Complete LED warranty terms available at [www.mercltg.com](http://www.mercltg.com).
- Actual performance may differ as a result of end-user environment and application.
- Most LED luminaires are suitable to operate in ambient temperatures from -20C (-4F) to 25C (77F).
- The following exclusions apply: Luminaires with optional standby lighting option, integral lighting controls options, or wireless control options. Consult factory.
- LM-79 testing was measured under a controlled 25C (77F) ambient operating temperature.

### FEATURES:

- Extra-wide footprint linear ambient LED luminaire.
- Wide design for new installations or retrofitting of existing older fluorescent lighting systems.
- Conveniently covers up old ceiling lines and unpainted surfaces. A true 48" or 96" length corresponds to older fluorescent lengths.
- Architectural hybrid-shape high transmission acrylic diffuser surrounds the LED light source enabling a very wide and near-perfect light distribution.
- Diffuser has a contoured bottom and straight side panels which regress back into the housing. Optional diffuser (LW25 style) available.
- Contrasting squared-profile housing.
- Design allows for greater lumen packages which are useful for the higher ceilings in gymnasiums, big box retailing, and industrial facilities.
- Custom formulated high diffusion acrylic material allows for maximum light transmission while eliminating pixilation and hot spots.
- Available module lengths: 2Ft. (24"), 4Ft. (48") or 8Ft. (96").
- Digital LED technology provides high efficacy and energy efficiency.
- Multiple power and light levels are offered as standard to allow meeting design and energy needs per application. Custom factory set levels available on request.
- Lumen maintenance; Reported L70 (hours) & L80 (hours) > 60,000.
- CRI greater than 80.
- Fixture lumens per watt ratios up to 139.
- American Made.



## LW26 SERIES

Fixture Type:

**ORDERING DATA:** Fill in boxes below with corresponding bold options.

Example: LW26-4-4800-35K-HTA-1%-UNI-EM7

SERIES	NOMINAL LENGTH (FT)	NOMINAL LUMENS	COLOR TEMP	DIFFUSER	DRIVER	VOLTAGE	OPTIONS
LW26	2	24"L 2300	30K	HTA	1%	UNI	Standby Modules
LW26A	4	48"L 2500	35K	High Transmission Acrylic	0-10V 1% Dimming		EM7
	8	96"L 2400	40K		As Specified		EM10
		3150	50K				EM12
		4500	Upon Request				Optional Integral Lighting Controls
		4800					01
		8400					Leviton OSFHU mounts externally, for higher ceilings.
		14000					04
		96"L					Wattstopper FS-155-1 mounts internally with only the PIF dome visible.
		6300					05
		8850					Leviton OSFHU mounts internally with only the PIF dome visible.
		28000					
		XXXX					Custom Lumen Package. Contact Factory.

### PHOTOMETRICS:

All photometric reports are available at [www.mercltg.com](http://www.mercltg.com).

### CROSS SECTIONS:

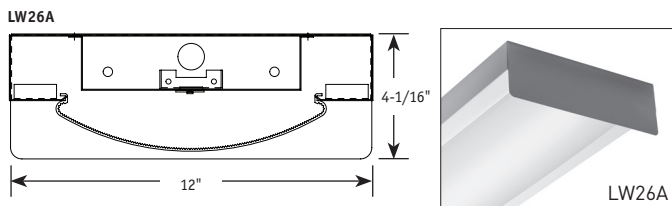
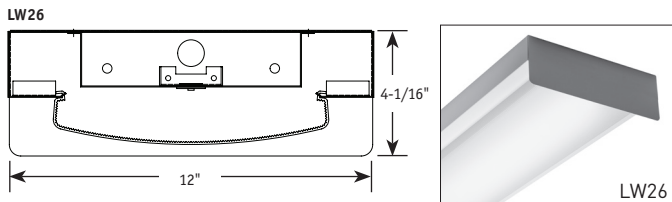

### LUMEN PACKAGE

SERIES	NOMINAL LENGTH (FT)	Nominal Lumen Package	Color	Fixture Power (W)	Delivered Lumens	Fixture LPW	Standby Lighting Option	DLC
LW26	2	2300	3000K	21	2265	108	-	-
		2300	3500K	21	2301	110	-	-
		2300	4000K	21	2372	113	-	-
		2300	5000K	21	2443	117	-	-
		2500	3000K	22	2392	107	-	-
		2500	3500K	22	2429	108	-	-
		2500	4000K	22	2504	112	-	-
		2500	5000K	22	2580	115	-	-

SERIES	NOMINAL LENGTH (FT)	Nominal Lumen Package	Color	Fixture Power (W)	Delivered Lumens	Fixture LPW	Standby Lighting Option	DLC
LW26	4	2400	3000K	21	2317	111	✓	✓
		2400	3500K	21	2354	113	✓	✓
		2400	4000K	21	2427	116	✓	✓
		2400	5000K	21	2499	120	✓	✓
		3150	3000K	29	3008	104	✓	✓
		3150	3500K	29	3055	106	✓	✓
		3150	4000K	29	3150	109	✓	✓
		3150	5000K	29	3244	112	✓	✓
		4500	3000K	39	4314	109	✓	✓
		4500	3500K	39	4382	111	✓	✓
		4500	4000K	39	4517	115	✓	✓
		4500	5000K	39	4653	118	✓	✓
		4800	3000K	43	4622	108	✓	-
		4800	3500K	43	4694	109	✓	✓
		4800	4000K	43	4840	113	✓	✓
		4800	5000K	43	4985	116	✓	✓
		8400	3000K	75	8,021	107	-	-
		8400	3500K	75	8,147	109	-	-
		8400	4000K	75	8,399	112	-	-
		8400	5000K	75	8,651	116	-	-
		14,000	3000K	129	13,442	104	-	-
		14,000	3500K	129	13,653	106	-	-
		14,000	4000K	129	14,075	109	-	-
		14,000	5000K	129	14,497	112	-	-

SERIES	NOMINAL LENGTH (FT)	Nominal Lumen Package	Color	Fixture Power (W)	Delivered Lumens	Fixture LPW	Standby Lighting Option	DLC
LW26	8	6300	3000K	47	6005	129	✓	✓
		6300	3500K	47	6100	131	✓	✓
		6300	4000K	47	6288	135	✓	✓
		6300	5000K	47	6477	139	✓	✓
		8850	3000K	77	8434	110	✓	✓
		8850	3500K	77	8566	112	✓	✓
		8850	4000K	77	8831	115	✓	✓
		8850	5000K	77	9096	119	✓	✓
		28,000	3000K	267	27,671	103	-	-
		28,000	3500K	267	28,106	105	-	-
		28,000	4000K	267	28,975	108	-	-
		28,000	5000K	267	29,844	112	-	-

Actual wattage may differ by +/- 5% when operating between 120V-277V +/- 10%.

### HANGING ACCESSORIES

PART #	DESCRIPTION	PART #	DESCRIPTION
R5PF-100	Round 5" power feed canopy, Hanging hardware, 100" long 1/16" cable.	VH-XX	"V" Hanger w/XX= 48"L or 72"L Chain & "S" Hook
R5-100	Round 5" canopy, Hanging hardware, 100" long 1/16" cable.	CPYS-1	S-1 Single Stem 5" Dia. Canopy
R2-100	Round 2" canopy, Hanging hardware, 100" long 1/16" cable.	STMXX	XX= 12"L, 24"L, 48"L Stem/ 3/8" IPS-5/8" OD
S5PF-100	Square 5" power feed canopy, Hanging hardware, 100" long 1/16" cable.	Other cable lengths available.	
S5-100	Square 5" canopy, Hanging hardware, 100" long 1/16" cable.		
S2-100	Square 5" power feed canopy, Hanging hardware, 100" long 1/16" cable.		

